

# ROCKFON® KORAL™

- **Attractive micro-textured white surface** ideal for straightforward ceiling designs
- **Offers excellent acoustics**, fire Class A1 and dimensionally stable even at humidity levels of up to 100%
- **Available in a variety of edges and formats**, suitable for many areas



## PRODUCT DESCRIPTION

- Stone wool panel
- Visible side: micro-textured white painted fleece
- Rear side: back fleece
- Painted edges

## ASSORTMENT

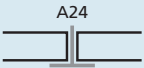
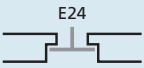
Edge detail	Module size (mm)	Weight (kg/m <sup>2</sup> )	Installation system
 A15	600 x 600 x 15	1.9	T15
 A24	600 x 600 x 15 1200 x 600 x 15 1800 x 600 x 20	1.9 1.9 2.4	T24
 E15	600 x 600 x 15 1200 x 600 x 15	2.5 2.5	T15
 E24	600 x 600 x 15 1200 x 600 x 15	2.5 2.5	T24

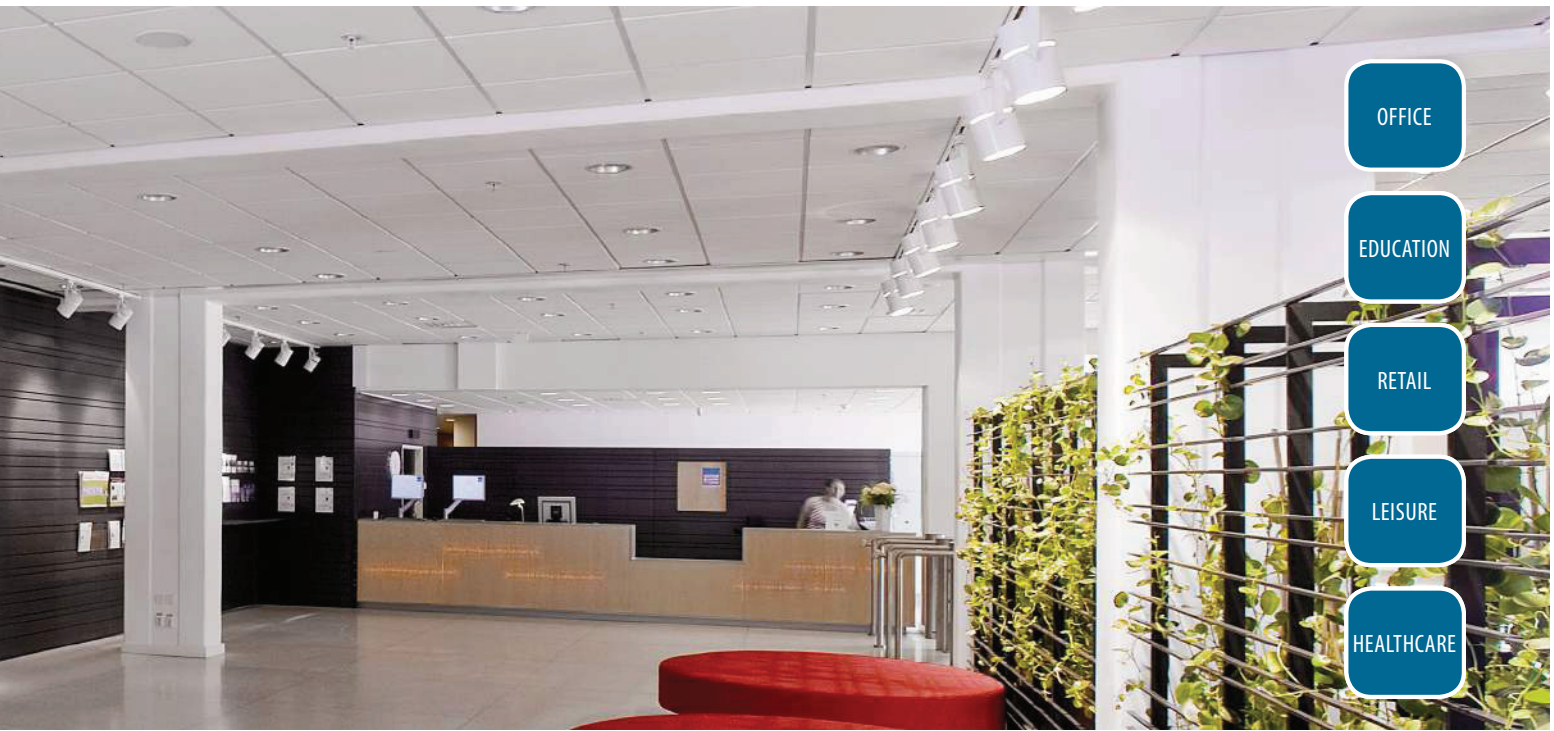

## PERFORMANCES



### Sound absorption

$\alpha_w$  up to 0.95 (Class A)

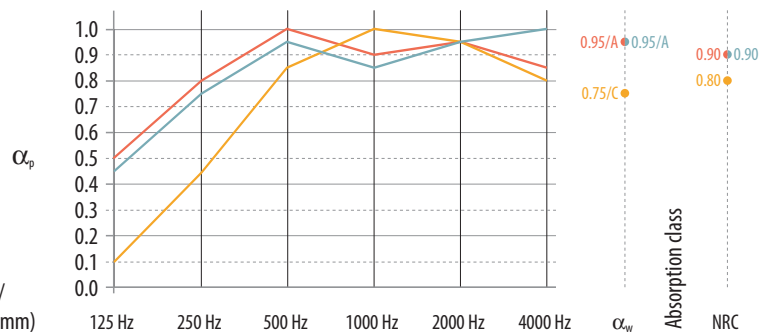

Edge / Thickness (mm) /  
Suspension (incl. tile – mm)

		125 Hz	250 Hz	500 Hz	1000 Hz	2000 Hz	4000 Hz	$\alpha_w$	Absorption class	NRC
	A / 15 / 200	0.50	0.80	1.00	0.90	0.95	0.85	0.95	A	0.90
	A / 15 / 50	0.10	0.45	0.85	1.00	0.95	0.80	0.75	C	0.80
	E / 15 / 200	0.45	0.75	0.95	0.85	0.95	1.00	0.95	A	0.90



### Reaction to fire

A1



### Light reflection

86%



### Humidity & sag resistance

Up to 100% RH  
1/C/0N



### Cleaning

Vacuum  
Damp cloth



### Hygiene

Stone wool provides  
no sustenance to  
microorganisms



### Environment

100% recyclable



### Indoor environment

A selection of ROCKFON  
products have been awarded

